

Customer Information Sheet

DRAWING No.: P25-XX26

SHEET 2 OF 2

IF IN DOUBT - ASK

©

NOT TO SCALE

THIRD ANGLE PROJECTION

ALL DIMENSIONS IN mm

ORDER CODE:
P25-XX26
 PROBE HEAD
 VARIANT (SEE BELOW)

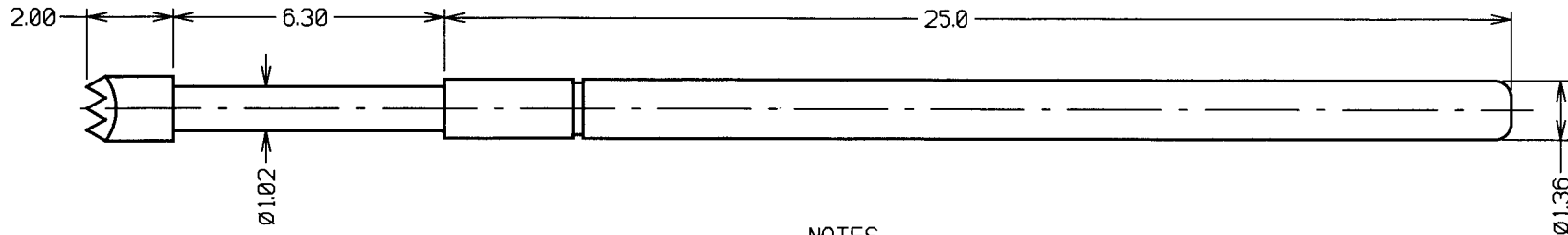

- NOTES:
 1. TO BE USED WITH SLEEVES S25-XX6.
 2. SUITABLE FOR A MINIMUM DISTANCE BETWEEN CENTRES OF 2.54mm.

PROBE HEAD VARIANTS

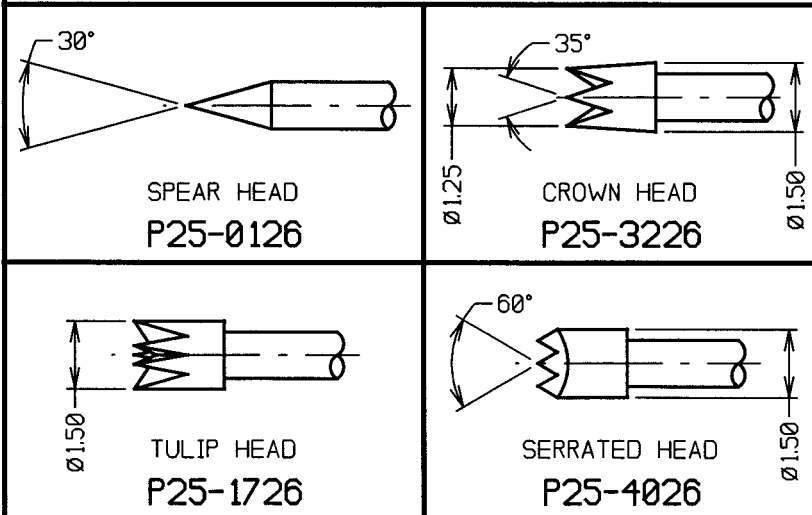

SPECIFICATIONS:

MATERIAL:

PLUNGER = BERYLLIUM COPPER
 BARREL = PHOSPHOR BRONZE
 SPRING = MUSIC WIRE

FINISH:

PLUNGER = RHODIUM OVER HARD NICKEL
 BARREL = GOLD
 SPRING = GOLD

ELECTRICAL:

CURRENT RATING = 3A
 CONTACT RESISTANCE = 30 MILLIOHMS

MECHANICAL:

FULL TRAVEL = 6.30mm
 SPRING FORCES:
 AT FULL TRAVEL = 3.43N ±0.69N (350g ±20%)
 AT 2/3 TRAVEL = 2.26N ±0.45N (230g ±20%)

2	07.03.01	5730
ISS.	DATE	C/NOTE
APPROVED: <i>[Signature]</i>		
CHECKED: <i>[Signature]</i>		
DRAWN: W. J. BOURNE		
CUSTOMER REF.:		
ASSEMBLY DRG.:		

HARWIN

THIS DRAWING AND ANY INFORMATION OR DESCRIPTIVE MATTER SET OUT HEREON ARE CONFIDENTIAL AND COPYRIGHT PROPERTY OF THE HARWIN GROUP AND MUST NOT BE DISCLOSED, LOANED, COPIED OR USED FOR MANUFACTURING, TENDERING OR FOR ANY OTHER PURPOSE WITHOUT THEIR WRITTEN PERMISSION

TOLERANCES

X. - ±1mm
 X.X - ±0.25mm
 X.XX - ±0.10mm
 X.XXX - ±0.01mm
 ANGLES - ±1°
 UNLESS STATED

MATERIAL:

SEE ABOVE

FINISH: SEE ABOVE

S/AREA: mm²

TITLE:

2.54mm MIN. CENTRE
 TWO-PIECE SPRING PROBE

DRAWING NUMBER:

P25-XX26

HARWIN INC
 U.S.A.
 TEL: (812) 285 0055
 FAX: (812) 285 0056

HARWIN PLC
 U.K.
 TEL: 023 9237 0451
 FAX: 023 9231 4590

HARWIN PTE
 SINGAPORE
 TEL: 65 7794909
 FAX: 65 7793868

SHT
 2
 OF
 2